

UPDATED LIST

niagara
framework®

Compatible Drivers & Applications

NIAGARA COMMUNITY HAS A DRIVER FOR EVERY NEED

Niagara Framework® offers an open platform that developers all over the world are utilizing to create solutions to real-world problems. This fast growing collection of drivers is unmatched in the industry. In many cases, the right driver for your integration work is available off-the-shelf from one of our development partners. This document strives to list all drivers available for purchase or, in some cases, for free at the current time. Note that Tridium has not tested all listed drivers and does not certify conformance. We have compiled this list as a convenience to our customers and, as new offerings are introduced by Niagara Community developers all the time, it may not be comprehensive. If you don't find the driver or application you are looking for on this list, the openness of the Niagara environment means you can relatively easily develop the solution you need. Moreover, Tridium's developer support team and others in the Niagara Community are here to help.

TRIDIUM

| Driver Name | System Detail | Type of System | Developer | For More Information | Connection Type | Niagara Platform | Niagara Version |
|--|---|--|----------------------|------------------------------------|---|----------------------|-------------------------------------|
| Accruent Alarm Driver | Send configured alarms to the accruent server | Any system that generates an Alarm including HVAC, Refrigeration and Lighting | Accruent | | IP | JACE | AX and N4 |
| Accruent Configuration Driver | To clone the JACE device to the Accruent system for mapping telemetry data values | Any System that needs a collection of Telemetry data or changing values on a JACE | Accruent | N/A | IP | JACE | AX and N4 |
| Accruent IOT Driver | Works with the Accruent Configuration Driver to change the values on a JACE from the Accruent System | Any System that needs values changed for a period of time including Turning on/off Lights, Temps on HVAC and Refrigeration Devices Mainly. | Accruent | N/A | IP | JACE | AX and N4 |
| Accruent Telemetry Driver | Transmits telemetry data from interesting points to the Accruent system for further processing and analysis | Any system that can be distilled into operational information using the Accruent rules engine | Accruent | N/A | IP | JACE | AX and N4 |
| Alarm Console (Enhanced) | Multi Client, Multi Group, Multi Workstation | Building Automation | MaxLine | controlsplus.uk.com | TCP/HTTP/UDP, configurable | JACE® and Supervisor | AX3.4 and higher N4.0 and higher |
| Allen Bradley CIP Driver | Allen Bradley AbLogix5, PLC/SLC 2 and 5 | Building Automation | Infocon/MaxLine | controlsplus.uk.com | Ethernet using , 1756-ENBT/A Ethernet module or 1769-L32E Ethernet port | JACE and Supervisor | AX3.4 and higher N4.0 and higher |
| Allen Bradley CSPV4 TCP Driver | Allen Bradley | Building Automation | Infocon/MaxLine | controlsplus.uk.com | TCP | JACE and Supervisor | AX3.4 and higher N4.0 and higher |
| American Auto-Matrix PHP | AAM PHP version 8.10 | Building Automation | Tridium | tridium.com or niagara-central.com | Serial RS-232 or RS-485 | JACE | AX3.0 and higher N4.0 and higher |
| American Auto-Matrix PUP | AAM PUP version 8.35 | Building Automation | Tridium | tridium.com or niagara-central.com | Serial RS-232 or RS-485 | JACE | AX3.0 and higher N4.0 and higher |
| Andover AC256 | Andover AC256 | Building Automation | Tridium | tridium.com or niagara-central.com | Serial RS-232 | JACE | AX3.0 and higher N4.0 and higher |
| Andover Infinity/ Continuum Driver | Andover Infinty | Building Automation | Tridium | tridium.com or niagara-central.com | Serial RS-233 | JACE | AX3.2 and higher N4.0 and higher |
| Apollo Open Connect Driver (Native Driver) | Apollo Fire Detectors Ltd | Fire & Security | Tyrrell Products Ltd | tyrrellproducts.com | Serial to Apollo Open Connect | JACE | AX3.5 and higher |
| ASI Controls Driver | ASIC 6000, 8055, 8255, 8355, 8655, 8755 | Building Automation | MaxLine | controlsplus.uk.com | Serial | JACE | AX3.4 and higher N4.0 and higher |
| Autani Driver | Autani Corporation's Energy Center family of products | Building Automation, Energy Control and Management System supporting HVAC, lighting, metering, plug loads and more | Autani Corporation | autani.com or sales@autani.com | TCP/IP | JACE and Supervisor | AX3.6 and higher |
| Automated Logic WebCTRL® SOAP Driver | WebCTRL Building Automation System | Building Automation | QuickLink Solutions | quicklink-solutions.com | TCP/IP | JACE and Supervisor | AX3.6 and higher |
| AXIS IP Driver | AXIS IP Cameras | Video Integration | Tridium | tridium.com or niagara-central.com | IP | JACE and Supervisor | AX3.4 and higher |
| BACnet MSTP Driver | BACnet MSTP Devices | Building Automation | Tridium | tridium.com or niagara-central.com | RS-485 | JACE | AX3.0 and higher N4.0 and higher |
| BACnet/IP Driver | BACnet IP Devices- esBACnet Ethernet Devices | Building Automation | Tridium | tridium.com or niagara-central.com | Ethernet IP | JACE and Supervisor | AX3.0 and higher N4.0 and higher |
| Barber Colman ASD | Barber Colman ASD | Building Automation | MaxLine | controlsplus.uk.com | Serial | JACE | AX3.4 and higher N4.0 and higher |
| Barber Colman GCM | Barber Colman GCM | Building Automation | MaxLine | controlsplus.uk.com | Serial | JACE | AX3.4 and higher N4.0 and higher |

| Driver Name | System Detail | Type of System | Developer | For More Information | Connection Type | Niagara Platform | Niagara Version |
|---|--|---|--------------------------------|--|---|---------------------|-------------------------------------|
| Barber-Colman N8K Driver | GCM - Network 8000 | Legacy Invensys Barber-Colman N8K GCM | Kodaro | https://www.kodaro.com/drivers | Serial/IP | JACE and Supervisor | Any AX version |
| BECKHOFF ADS Driver | BECKHOFF | Industrial Automation & Building Automation | pi-System GmbH | info@pi-system.ch | TCP-IP | JACE and Supervisor | AX3.5 and higher |
| Carel - SSI-DR-CAREL | Carel Controllers | Refrigeration, Air Conditioning | Smart Services International | contact@smarts-int.com | Serial | AX | Any AX version |
| Carel Driver | IR32, MPX, IR33, pCO, pCO II, IOM, EVD | Refrigeration, Air Conditioning | QuickLink Solutions | quicklink-solutions.com | Serial RS-485 | JACE® | AX3.4 and higher |
| CCN Driver | Carrier Comfort Network | Building Automation | Tridium | tridium.com or niagara-central.com | Serial RS-485 | JACE | AX3.4 and higher N4.0 and higher |
| Clipsal Cbus Driver | Clipsal (now Schneider) Cbus | Building/Lighting | MaxLine | controlsplus.uk.com | Serial and TCP (CNI) | JACE | AX3.4 and higher N4.0 and higher |
| Clipsal CgateTCP Driver | Clipsal (now Schneider) Cgate TCP | Building Automation | MaxLine | controlsplus.uk.com | TCP | JACE | AX3.4 and higher N4.0 and higher |
| CNS-Enocean | EnOcean Wireless Network Devices | Building Automation | Control Network Solutions Ltd. | cns-enocean.com | Ethernet | JACE and Supervisor | AX3.5 and higher N4.0 and higher |
| CSI Inet driver | CSI TAC I/Net 7801X | Building Automation | MaxLine | controlsplus.uk.com | Serial | JACE | AX3.4 and higher N4.0 and higher |
| CSV Mapper | Convert CSV files into Niagara Histories | Building Automation | ActiveLogix | https://www.activelogix.com/ifttt/ | IP | Supervisor | AX and N4 |
| CSV/File Driver | CSV/FTP/sFTP/XML | Import/Export CSV, XML, FTP files as points | Kodaro | https://www.kodaro.com/drivers | IP/Ethernet | JACE and Supervisor | Any AX release, N4.0 and higher |
| Cyclon-Unitron UC32 | Cyclon Controls | Building Management Retrofit | Baudrate | https://baudrate.io/ | TCP/IP | Jace and Supervisor | AX3.6 and above |
| Dali connect master driver | DALI | Lighting and environmental control and design | Dali Smart Link | dalismartlink.com | DALI/RS485 | JACE and Supervisor | AX3.6 and higher |
| Danfoss - SSI-DR- DANBUSS | Danfoss controllers communicating with Danbuss | Refrigeration | Smart Services International | contact@smarts-int.com | Serial | JACE | Any AX version |
| Danfoss - SSI-DR- DANLON | Danfoss controllers communicating with Lon | Refrigeration | Smart Services International | contact@smarts-int.com | Lon | JACE | Any AX version |
| Danfoss - SSI-DR- DNIP | Danfoss controllers communicating with DNIP | Refrigeration | Smart Services International | contact@smarts-int.com | TCP-IP | JACE | AX3.5 and higher |
| Danfoss - SSI-DR-DNIP20 | Danfoss controllers communicating with DNIP | Refrigeration | Smart Services International | contact@smarts-int.com | TCP-IP | JACE | AX3.5 and higher |
| Danfoss - SSI-DR-MODBUS | Danfoss controllers communicating with Modbus | Refrigeration | Smart Services International | contact@smarts-int.com | Serial | JACE | Any AX version |
| Danfoss 3rd- Generation - SSI-DR-DANFOSS-3G | AK-SM850, AK-SM820, AK-SC355, AK-SC255, AK-SM350 | Refrigeration | Smart Services International | contact@smarts-int.com | TCP-IP | JACE | AX3.5 and higher |
| Danfoss Danbuss driver for AKC devices | AKC25H1, AKC25H3, AKC114A, AKC115A, EKC201C, EKC531D1, EKC414A1, EKC204A | Refrigeration | QuickLink Solutions | quicklink-solutions.com | Serial RS-232 through AKA24x gateway | JACE | AX3.4 and higher |
| Danfoss Driver | Danfoss AK255 Devices | Commerical Refrigeration | SSI | tridium.com or niagara-central.com | TCP/IP | JACE | AX3.7 and higher |
| Danfoss Lon Works driver for EKC devices | EKC series devices | Refrigeration | QuickLink Solutions | quicklink-solutions.com | LonWorks through TP78-05 (Network Bridge FTT10-RS485) | JACE | AX3.4 and higher |
| Dedicated Micros Driver | Dedicated Micros DVRs and IP Cameras | Video Integration | Tridium | tridium.com or niagara-central.com | IP | JACE and Supervisor | AX3.4 and higher |
| DIRC | DotControls IRC | Home & building automation | SAFECONTROL | www.safecontrol.cz http://license.safecontrol.cz | IP | JACE and Supervisor | N4.4 and higher |

| Driver Name | System Detail | Type of System | Developer | For More Information | Connection Type | Niagara Platform | Niagara Version |
|---|--|--|------------------------------|--|--|---|-------------------------------------|
| Dixell – SSI-DR-DIXELL | Dixell Controllers | Refrigeration, Air Conditioning | Smart Services International | contact@smarts-int.com | Serial | JACE | Any AX version |
| Dixell – SSI-DR-XWEB | All X-WEB product series | Refrigeration, Air Conditioning | Smart Services International | contact@smarts-int.com | IP/Ethernet | JACE and Supervisor | AX3.4 and higher |
| Dixell Driver for X-WEB gateway | X-WEB gateway 500, | Refrigeration, Air Conditioning | QuickLink Solutions | quicklink-solutions.com | IP/Ethernet | JACE and Supervisor (only IP in the same LAN) | AX3.4 and higher |
| DNP3 Driver | DNP3 (Distributed Network Protocol) | DNP3 compatible devices | Kodaro | https://www.kodaro.com/drivers | IP/Ethernet | JACE and Supervisor | Any AX release |
| EasyTunnel | Create a secure tunneling between JACEs and Web Supervisor without a static IP address in the JACE | Building Automation | QuickLink Solutions | quicklink-solutions.com | IP | JACE and Supervisor | AX3.5 and higher |
| eBMS Video Door Entry | Enables JACE station access to concierge voice and video | Concierge | Tyrrell Products Ltd | tyrrellproducts.com | IP | JACE and Supervisor | AX3.5 and higher |
| eBMS/Mobile License | Enables mobile device app to access JACE station | Mobile UI | Tyrrell Products Ltd | tyrrellproducts.com | IP | JACE and Supervisor | AX3.5 and higher |
| Echo Driver | Enables Amazon Echo Devices to control Niagara based systems. | Building automation, Lighting and environmental control, hvac, residential appliances, voice control, room control | Tyrell Products Ltd | www.tyrellproducts.com | IP | Jace and Supervisor | Ax3.8 and N4.3 |
| ED310 | ZPA (EN 62056-21) | Smart metering | SAFECONTROL | www.safecontrol.cz and http://license.safecontrol.cz | RS485 | JACE and SUPERVISOR | AX 3.6 |
| EIB/KNX Driver | EIBNET/IP Devices | Building Automation | Tridium | tridium.com or niagara-central.com | IP | JACE and Supervisor | AX3.1 and higher N4.0 and higher |
| elitedali™ | DALI lighting | Intelligent lighting control | Control Network Solutions | elitedali.com | DALI | JACE and Supervisor | AX3.6 and higher |
| Emerson Climate Communication Driver for Multiflex I/O Boards | Emerson Multiflex I/O | Building Automation | QuickLink Solutions | quicklink-solutions.com | Optional card or external IP interface | JACE 6 or JACE 7 only | AX3.4 and higher |
| E-Mon EZ7 Driver | E-Mon EZ7 Protocol | E-Mon Class 3000/5000/V-Class/ IDR devices | Kodaro | https://www.kodaro.com/drivers | Serial/IP | JACE and Supervisor | Any AX release |
| Energy Star Driver | Access and Display Building Metrics from Portfolio Manager | Building Automation | ActiveLogix | https://www.activelogix.com/ifttt/ | IP | Supervisor | AX and N4 |
| ESSER | Esser IQ8Control & FlexES | Fire & Security | SAFECONTROL | www.safecontrol.cz http://license.safecontrol.cz | RS232/IP | JACE and SUPERVISOR | AX 3.6 and higher / N4.4 and higher |
| Etherios Device Cloud | JENE-PC6000 | Building Automation | Connex Energy | connexenergy.com | IP | JACE | AX3.0 and higher |
| EtherNet Industrial Protocol (Ethernet/ IP) Driver | A variety of PLC's devices that support Ethernet IP (Industrial Protocol) including Allen Bradley | Industrial Data Acquisition and Control Equipments | Forest Rock Systems Ltd | forestrook.co.uk | IP | JACE | AX3.6 and higher |
| Fidelio Hotel Management Driver | Micros Fidelio or Opera | Hotel Booking System | Tridium Europe Ltd. | tridumeurope.com | IP | JACE® and Supervisor | AX3.2 and higher |
| FLEX Serial Driver | Simple Serial communicating devices | Generic | Tridium | tridium.com or niagara-central.com | Serial RS-232 or RS-485 | JACE | AX3.1 and higher N4.0 and higher |
| Foxhole Driver | Niagara AX | Communicate Niagara Station to Station between firewalls with ease | Kodaro | https://www.kodaro.com/drivers | IP/Ethernet | JACE and Supervisor | Any AX release |
| GCMAscend | Barber Colman GCM Network Controller Driver | Building Automation | Kodaro | http://www.kodaro.com/products/driver-software.html | | | AX3.6+ N4 (4.2.36.34.1) |

| Driver Name | System Detail | Type of System | Developer | For More Information | Connection Type | Niagara Platform | Niagara Version |
|--|---|--|------------------------------|--|---------------------|--------------------------------|-------------------------------------|
| Gent Vigilon Fire Panel Driver | Gent Vigilon Fire panels | Building fire systems | Forest Rock Systems Ltd | forestrocks.co.uk | Serial | JACE | AX3.2 and higher |
| Grundfos Genibus Driver | Grundfos Pumps with genibus comms option | HVAC | Ontrol | ontrol.com | Serial | JACE | AX3.7 and higher |
| Haystack+ | Haystack can migrate building analytics data to Niagara | Building Automation | Kodaro | http://www.kodaro.com/products/driver-software.html | | | N4 V1.0.17.8 V1.0.17.1 |
| Helvar IP Driver | Helvar 905, 810 & | Lighting Controls | Ontrol | ontrol.com | IP/Ethernet | JACE and Supervisor | AX3.7 and higher |
| HID Asure ID Driver | PC running Asure ID software | Photo ID/Badging Software | Tridium | tridium.com or niagara-central.com | IP | Enterprise Security Supervisor | Enterprise Security 2.2 |
| HLC-IPDRV | Helvar 905, 910 & | Lighting Controls (DALI Lighting Control System) | Helvar | helvar.com/content/driver-tridium-integration-system | IP | JACE and Supervisor | AX3.6 and higher |
| Honeywell Cbus TCP Driver | Honeywell Cbus bus driver (hardware + software solution) | Building Automation | MaxLine | controlsplus.uk.com | TCP link to MIG112 | JACE and Supervisor | AX3.4 and higher N4.0 and higher |
| Honeywell EvoHome Driver | Honeywell EvoHome System | Room controls | Tridium Europe Ltd. | tridumeurope.com | Serial | JACE | AX3.7 and higher |
| Honeywell Galaxy Driver | Honeywell Galaxy Dimension security panels | Security and Access Control | QuickLink Solutions | quicklink-solutions.com | Serial RS-232 or IP | JACE and Supervisor | AX3.5 and higher |
| Honeywell Genus – SSI-DR-GENUS | Honeywell Genus system | Refrigeration | Smart Services International | contact@smarts-int.com | Serial | JACE | Any AX version |
| Honeywell Rapid EYE Driver | Rapid EYE DVRs | Video Integration | Tridium | tridium.com or niagara-central.com | IP | JACE and Supervisor | AX3.5 and higher |
| Horstmann Mainscomm | Horstmann Poweline | Enables reading of meters via powerline | Tridium | tridium.com or niagara-central.com | RS-232 | JACE | AX |
| IEC 61850 MMS Driver | IEC-61850 Std | Substation relays, Industrial metering | Forest Rock Systems Ltd | forestrocks.co.uk | IP | JACE | AX3.2 and higher |
| IFTTT Driver | Connects Niagara 4 to Alexa | Comfort Control | ActiveLogix | https://www.activelogix.com/ifttt/ | IP | JACE and Supervisor | Niagara 4.4 and Higher |
| iLON Driver | iLON IP device driver | Supports Smart Server 2.0 and the iLON 100 e3 devices | Kodaro | https://www.kodaro.com/drivers | IP/Ethernet | JACE and Supervisor | Any AX release |
| ILON Driver | Lonworks IP Devices | Building Automation | Tridium | tridium.com or niagara-central.com | IP | JACE and Supervisor | AX3.3 and higher N4.0 and higher |
| iNELS ASCII | iNels wired system | Home & building automation | SAFECONTROL | www.safecontrol.cz http://license.safecontrol.cz | IP | JACE and SUPERVISOR | AX 3.8.111 / N4.4 and higher |
| INNCOM | CINnet | Hotel Control | Fastek | www.fastekintl.ca/ | RS-485 | | |
| Inovonics Driver | Inovonics USB to wireless | Connects to Universal Serial Receiver for wireless devices | Kodaro | https://www.kodaro.com/drivers | Serial | JACE® | Any AX release |
| Invoconics | Invoconics wireless Devices | Building Automation | Kodaro | http://www.kodaro.com/products/driver-software.html | Serial | JACE | AX 3.6.47.2, N4 V1.0.17.8 V1.0.17.1 |
| Johnson N2 Open driver | Johnson N2 devices, VMA, VND and others | Building Automation | MaxLine | controlsplus.uk.com | Serial | JACE | AX3.4 and higher N4.0 and higher |
| Johnson N2 Slave Serial Driver - JACE as VND | JACE acts as Johnson device on N2 network | Building Automation | MaxLine | controlsplus.uk.com | Serial | JACE | AX3.4 and AX3.5 only |
| Johnson N2 Slave TCP Driver - JACE as VND | JACE acts as Johnson device on N2 network - TCP to serial converter (MIG112) incl. in price | Building Automation | MaxLine | controlsplus.uk.com | Serial | JACE | AX3.6 and higher N4.0 and higher |
| Josam Grease Trap Driver | Josam EGLD series | Food Preparation | Tridium | tridium.com or niagara-central.com | Serial RS-232 | JACE | |
| LON FTT10 Driver | Lonworks FTT10 Devices | Building Automation | Tridium | tridium.com or niagara-central.com | FTT10 | JACE | AX3.0 and higher N4.0 and higher |
| MAXPRO Driver | MAXPRO NVR | Video Integration | WEBs | security.honeywell.com | IP | JACE and Supervisor | AX3.6 and higher |

| Driver Name | System Detail | Type of System | Developer | For More Information | Connection Type | Niagara Platform | Niagara Version |
|--|--|------------------------------------|------------------------------|---|-------------------------|--|-------------------------------------|
| M-Bus Driver | M-Bus Master Devices | Building Automation/ Energy | Tridium | tridium.com or niagara-central.com | Serial RS-232 | JACE | AX3.2 and higher N4.0 and higher |
| MCE Lift Driver | Motion Control Engineering - Lifts | Lift Systems | Forest Rock Systems Ltd | forestrook.co.uk | IP | JACE | AX3.2 and higher |
| McQuay Driver | McQuay MicroTech Open Protocol Master | Building Automation | Tridium | tridium.com or niagara-central.com | Serial RS-485 | JACE | AX3.4 and higher |
| Milestone Driver | Milestone DVRs and IP Cameras | Video Integration | Tridium | tridium.com or niagara-central.com | IP | JACE and Supervisor | AX3.4 and higher |
| Modbus IP Driver | Modbus IP Devices | Building Automation, Metering etc. | Forest Rock Systems Ltd | forestrook.co.uk | IP | JACE | |
| Modbus RTU Driver | Modbus RTU Devices | Building Automation | Tridium | tridium.com or niagara-central.com | Serial RS-232 or RS-485 | JACE | AX3.0 and higher N4.0 and higher |
| Modbus RTU Slave Driver | Enables JACE to function as a Modbus RTU Slave Device | Building Automation | Tridium | tridium.com or niagara-central.com | Serial RS-232 or RS-485 | JACE | AX3.0 and higher N4.0 and higher |
| Modbus TCP Driver | Modbus TCP Devices | Building Automation | Tridium | tridium.com or niagara-central.com | TCP-IP | JACE and Supervisor | AX3.0 and higher N4.0 and higher |
| Modbus TCP Slave Driver | Enables Station to function as a Modbus TCP Slave Device | Building Automation | Tridium | tridium.com or niagara-central.com | TCP-IP | JACE and Supervisor | AX3.0 and higher N4.0 and higher |
| MQTT Client | MQTT client driver | Enterprise Integration | Tridium | tridium.com or niagara-central.com | IP | JACE and Supervisor | N4.2 and higher |
| Neopsis C-Bus Connectivity Kit | Honeywell C-Bus | Building Automation | Neopsis | neopsis.com | Serial/IP | JACE and Supervisor | AX3.4 and higher |
| Niagara AX Tunneling Driver | VPN Tunneling for Niagara AX without Fixed IP | All Niagara AX Applications | Smart Services International | contact@smarts-int.com | TCP-IP | JACE and Supervisor | AX3.5 and higher |
| Notifier AM series CEI-ABI driver for Italian Market | Notifier AM-2000, AM-4000 and | Fire Detection | QuickLink Solutions | quicklink-solutions.com | Serial RS-485 or | JACE or Supervisor (only IP in the same LAN) | AX3.4 and higher |
| Novar Driver | Novar UVC-03 and UVC-11 | Building Automation | MaxLine | controlsplus.uk.com | Serial | JACE | AX3.4 and higher N4.0 and higher |
| nProtex | Elevates Awareness of Niagara Security | Building Automation | ActiveLogix | https://www.activelogix.com/ifttt/ | IP | Supervisor | AX and N4 |
| oBIX Driver | oBIX servers | Enterprise Integration | Tridium | tridium.com or niagara-central.com | TCP-IP | JACE and Supervisor | AX3.1 and higher N4.0 and higher |
| OPC- DA Client Driver | Servers implementing OPC Data Access Specifications 1.x-2.x | Building Automation | Tridium | tridium.com or niagara-central.com | IP | Supervisor (Windows only) | AX3.0 and higher N4.0 and higher |
| OPC Server Driver | OPC Server | Building Automation | MaxLine | controlsplus.uk.com | TCP | Supervisor | AX3.4 and higher |
| OPC UA Client | OPC UA Client | Industrial Automation | Tridium | tridium.com or niagara-central.com | IP | JACE and Supervisor | Niagara 4.3 and higher |
| OPC UA Server | OPC UA Server | Industrial Automation | Tridium | tridium.com or niagara-central.com | IP | JACE and Supervisor | Niagara 4.3 and higher |
| OpenADR 2.0a VEN Driver | JENE-PC6000 | Building Automation | Connex Energy | connexenergy.com | IP | JACE | AX3.0 and higher |
| PostgreSQL Database Driver | PostgreSQL database 8.4, 9.0 and 9.1 | Generic | QuickLink Solutions | quicklink-solutions.com | JDBC | Supervisor | AX3.5 and higher |
| Qx Graphical Framework for Niagara AX | HTML5 graphical Framework for Niagara AX based on XSLT technology and oBIX with a new graphical user interface | Building Automation | QuickLink Solutions | quicklink-solutions.com | IP | JACE and Supervisor | AX3.6 and higher |
| RDBMS - DB2 | Relational DataBase Management Systems | DB2 | Tridium | tridium.com or niagara-central.com | IP | Supervisor | AX3.4 and higher |
| RDBMS - MySQL | Relational DataBase Management Systems | MySQL | Tridium | tridium.com or niagara-central.com | IP | Supervisor | AX3.4 and higher N4.0 and higher |

| Driver Name | System Detail | Type of System | Developer | For More Information | Connection Type | Niagara Platform | Niagara Version | |
|---|--|------------------------------------|------------------------------|--|---|---------------------|-------------------------------------|--|
| RDBMS - Oracle | Relational DataBase Management Systems | Oracle | Tridium | tridium.com or niagara-central.com | IP | Supervisor | AX3.4 and higher N4.0 and higher | |
| RDBMS - SQL Server | Relational DataBase Management Systems | SQLServer | Tridium | tridium.com or niagara-central.com | IP | Supervisor | AX3.4 and higher N4.0 and higher | |
| Resol Solar Water Heating Driver | Resol Vbus | Building Automation | Tridium Europe Ltd. | tridumeurope.com | Serial | JACE | AX3.3 and higher | |
| Robertshaw DMS Driver | Robertshaw DMS | Building Automation | MaxLine | Local MaxLine Distributor | Serial | JACE | AX3.4 and higher N4.0 and higher | |
| Robertshaw Microsmart Serial Driver | Robertshaw Microsmart 9.4C and above | Building Automation | MaxLine | Local MaxLine Distributor | Serial | JACE | AX3.4 and AX3.5 only | |
| Robertshaw Microsmart TCP Driver | Robertshaw Microsmart 9.4C and above TCP to serial converter (MIG112) incl. in price | Building Automation | MaxLine | controlsplus.uk.com | TCP link to MIG112 then Serial RS485 Microsmart | JACE | AX3.6 and higher N4.0 and higher | |
| Rotronic Hydroflex Driver | Hydroflex Series | Building Automation | Baudrate | https://baudrate.io/ | RS-485 or TCP/IP | JACE | AX and N4 | |
| SAFE CSV | Hotel system Horec | Hotel booking and room management | SAFECONTROL | www.safecontrol.cz safecontrol.cz | http://license. | IP | JACE and SUPERVISOR | AX 3.6 and higher / N4.4 and higher |
| SAFE SMS | Secomea Site Manager | Industrial Automation | SAFECONTROL | www.safecontrol.cz safecontrol.cz | http://license. | IP | JACE and SUPERVISOR | AX 3.8.111 / N4.4 and higher |
| Satchwell NCP | MN300, MN440, MN500, MN620, MN350, MN450, MN550, MN650 | Building Management Retrofit | Baudrate | https://baudrate.io/ | Serial RS-485 | JACE | AX | |
| Satchwell SNP | MMC 3601, MMC 4601, IAC 200, IAC 400, IAC 420, AC 600 | Building Management Retrofit | Baudrate | https://baudrate.io/ | Serial RS-485 | JACE | | |
| Sauter novaNet Driver | Sauter EY292 Router, Sauter EY291 | Building Automation, | Baudrate | https://baudrate.io/ | Serial, IP | JACE and Supervisor | AX and N4 | |
| Scheider Electric TAC Xenta Driver | Xenta Controller | Building Management Retrofit | Baudrate | https://baudrate.io/ | Lon | JACE | AX | |
| Schneider Electric OVA driver for Dardo Plus system | Dardo Plus Control Unit | Emergency Lighting | QuickLink Solutions | quicklink-solutions.com | Serial RS-485 | JACE® | AX3.4 and higher | |
| Schneider-Electric – SSI-DR-TELMEC | Schneider-Electric Touch Screens | Industrial Automation Touch Screen | Smart Services International | contact@smarts-int.com | Serial | JACE | Any AX release | |
| SegmentManager | WattStopper Digital Lighting Management | Lighting Controls | WattStopper | wattstopper.com/download-niagara-driver.aspx | BACnet/IP, BACnet MS/TP | JACE | AX3.4 and higher | |
| Siemens Apogee 600 TEC Driver | Siemens 600 FLN compatible devices | Building Automation | MaxLine | controlsplus.uk.com | Serial | JACE | AX3.4 and higher N4.0 and higher | |
| Siemens Desigo PX Driver | Siemens PXC Series, and PXR11 and PXR12 | Building Management Retrofit | Baudrate | https://baudrate.io/ | Lon | JACE | AX | |
| Siemens Sys600/ Apogee Driver | Siemens | Legacy Siemens Sys600 and Apogee | Kodaro | https://www.kodaro.com/drivers | Serial/IP | JACE and Supervisor | Any AX release | |
| Sierra Raven Driver | Sierra Raven Driver | Building Automation | Infocon/MaxLine | controlsplus.uk.com | Serial | JACE | AX3.4 and higher | |
| Simple OpenADR Driver | Akuacom DRAS | Demand Response | Tridium | tridium.com or niagara-central.com | IP | JACE and Supervisor | AX3.5 and higher | |
| SMS Driver | Send JACE & Supervisor SMS messages via GPRS or GSM modem | Building Automation | Tridium | tridium.com or niagara-central.com | GPRS or GSM Modem | JACE and Supervisor | AX3.1 and higher N4.0 and higher | |
| SMS Driver for Multirecipient, Multi-Group SMS | Axeon GSM, C35i GSM or similar | Building Automation | MaxLine | controlsplus.uk.com | Serial/TCP | JACE and Supervisor | AX3.4 and higher N4.0 and higher | |
| SNMP Driver | SNMP Devices (SNMPv1, SNMPv2 and SNMPv3) | Building Automation | Tridium | tridium.com or niagara-central.com | IP | JACE and Supervisor | AX3.0 and higher N4.2 and higher | |

| Driver Name | System Detail | Type of System | Developer | For More Information | Connection Type | Niagara Platform | Niagara Version |
|---|---|--|------------------------------|--|---|---------------------|-------------------------------------|
| SOAP Client | SOAP 1.2 configurable client able to import external services into the Niagara Framework® | Building Automation | QuickLink Solutions | quicklink-solutions.com | IP | JACE and Supervisor | AX3.5 and higher |
| SOAP Server | SOAP 1.2 configurable service able to export points, alarms schedules and histories | Building Automation | QuickLink Solutions | quicklink-solutions.com | IP | JACE and Supervisor | AX3.5 and higher |
| Solidyne M2/IZAC | M2 & IZAC family of Building Automation controls | Building Automation | Solidyne | solidyne.com/document/ M2XDriver.pdf | Serial Connection (RS-485) | JACE | AX3.6 and higher |
| SonNet Serial Driver | Sontay SonNet Wireless Sensing System | Temperature and RH sensing for building automation systems | Sontay | sontay.com or sales@sontay.com | Serial RS-232 | JACE | AX3.5 and higher |
| Staefa Smart 2 Driver | Staefa Smart 2 Driver, AETI-485 converter to purchase separately | Building Automation | MaxLine | controlsplus.uk.com | Serial | JACE | AX3.4 and higher N4.0 and higher |
| TAP Pager Driver | TAP (Telocator Alphanumeric Protocol) pagers | Building Automation | MaxLine | controlsplus.uk.com | Serial | JACE | AX3.4 and higher N4.0 and higher |
| TCOM Driver | EasyIO Controllers | Building Automation | MaxLine | controlsplus.uk.com | TCP | JACE and Supervisor | AX3.4 and higher N4.0 and higher |
| TCOMAX Driver | Niagara R2 JACE | Building Automation | MaxLine | controlsplus.uk.com | TCP | JACE and Supervisor | AX3.4 and higher |
| Tecnoalarm driver | TP8-64 BUS, TP16-256, TP16-512 | Intrusion Detection | QuickLink Solutions | quicklink-solutions.com | Serial | JACE® | AX3.5 and higher |
| Trane Comm3 Non-isolated Driver | Trane Comm Three Varitrane VAV | Building Automation | MaxLine | controlsplus.uk.com | Serial | JACE | AX3.4 and higher N4.0 and higher |
| Trane Comm4 Driver (Isolated) | Trane Comm Four devices | Building Automation | MaxLine | controlsplus.uk.com | Serial | JACE | AX3.4 and higher N4.0 and higher |
| Trend IQ2 Driver | Trend Control Systems EINC, IQEye, Xtend | Building Automation | Tyrrell Products Ltd | tyrrellproducts.com | Serial | JACE and Supervisor | AX3.6 and higher |
| Trend IQ2 serial Driver | Trend IQ2 serial devices | Building Automation | MaxLine | controlsplus.uk.com | Serial | JACE and Supervisor | AX3.4 and higher N4.0 and higher |
| Trend IQ3 Driver | Trend Control Systems | Building Automation | Tyrrell Products Ltd | tyrrellproducts.com | IP | JACE and Supervisor | AX3.6 and higher |
| Trend IQ3 TCP Universal Driver - all IQ3 networks including tunneling (replaces older EINC and IQ3 drivers) | IQ 3Xcte, IQ 3Xtend, IQ EINC and networked IQ2xx, IQ3xx, IQ4xx and IQL | Building Automation | MaxLine | controlsplus.uk.com | Serial | JACE and Supervisor | AX3.4 and higher N4.0 and higher |
| Trend IQx Driver | Trend IQ Controller IQeco, IQ1, IQ2, IQ3, and IQ4 | Building Automation | QuickLink Solutions | quicklink-solutions.com | TCP/IP protocol (EIN, IQ3, IQ4) | JACE and Supervisor | AX3.6 and higher |
| Twitter client for Niagara AX | Twitter | Building Automation | QuickLink Solutions | quicklink-solutions.com | IP | JACE and Supervisor | AX 3.5 and higher |
| Vaisala Driver | HMT140 Series | Building Management Retrofit | Baudrate | https://baudrate.io/ | Wifi | JACE and Supervisor | AX |
| Veeder Root Tank Level Driver | Veeder Root TLS-350 | Fuel Management | Tridium | tridium.com or niagara-central.com | Serial RS-232 and Ethernet | JACE | AX3.0 and higher |
| VISAPP | DotControls HVAC control | Home & building automation | SAFECONTROL | www.safecontrol.cz http://license.safecontrol.cz | IP | JACE and SUPERVISOR | N4.4 and higher |
| Weather Station | Davis Weather Station interface | Building Automation | Dali Smart Link | dalismartlink.com | RS232 | JACE | AX3.7 and higher |
| WEMS - SSI-DR- WEMS | WEMS wireless devices | Wireless Network | Smart Services International | contact@smarts-int.com | Wireless/TCP-IP | JACE and Supervisor | AX3.5 and higher |
| WEMS - SSI-DR- WEMSDIRECT | Wems direct driver for Niagara Framework® | Wireless Network | Smart Services International | contact@smarts-int.com | SSI wireless serial adapter/ Serial RS485 and RS232 | JACE and Supervisor | AX3.5 and higher |
| ZigBee | ZigBee Vykonstat | Building Automation | Vykon | www.vykon.com | RS485 | JACE and Supervisor | AX 3.5 and Higher |

Enterprise Application / Integration Architecture Powered by Niagara 4

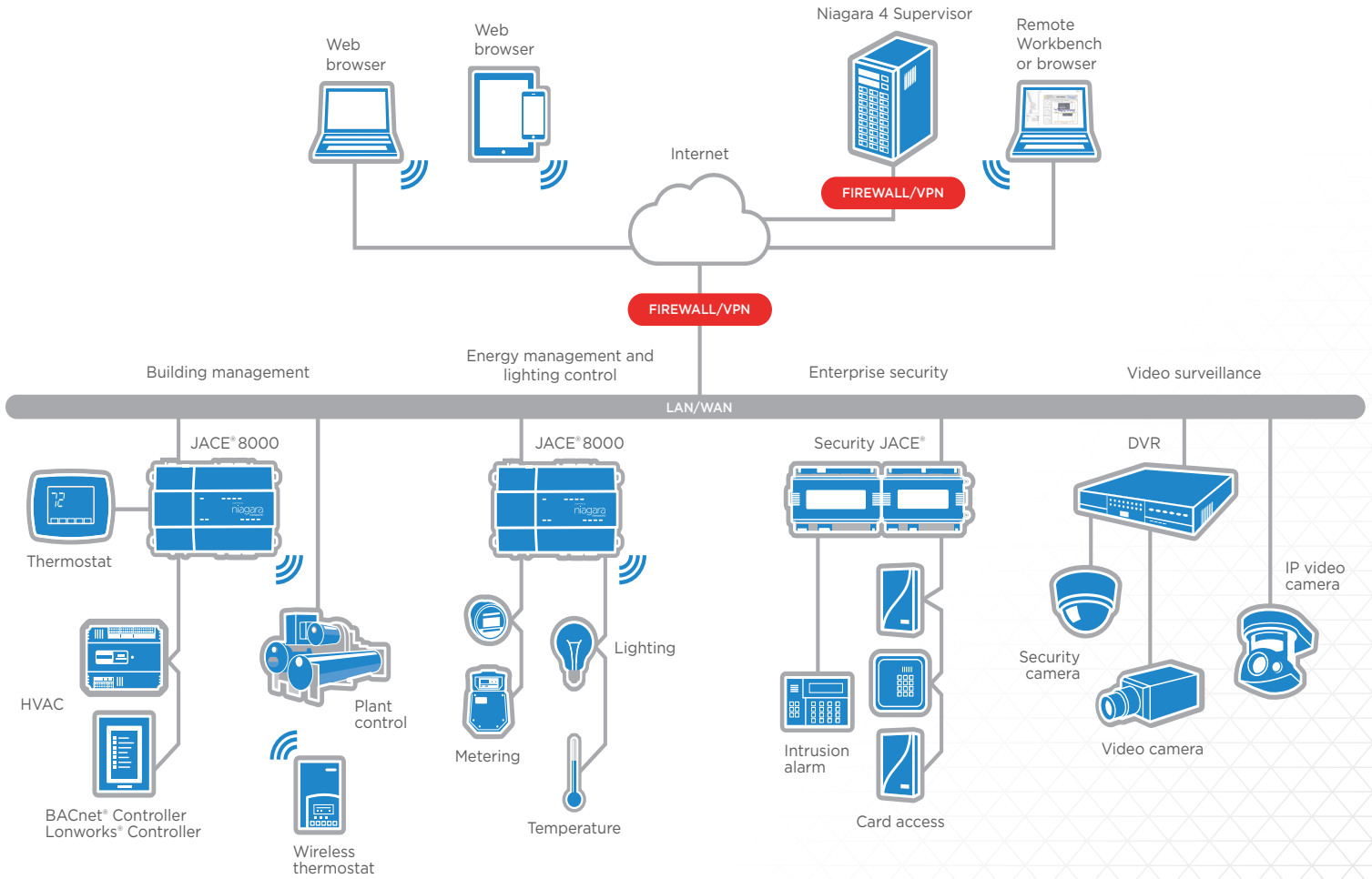

powered by
niagara
 framework®

Niagara Framework is available through a wide variety of original equipment manufacturers. Our open distribution business model and open protocol support allow a vendor-neutral application compatible with devices and systems throughout the world.

To learn more about how to purchase and install Niagara Framework, or if you are an original equipment manufacturer and would like to add Niagara Framework to your suite of offerings, please contact us.



tridium.com

Locations and customer support, worldwide

Headquarters
 North America
 1 804 747 4771

Support
 North America & Latin America
 1 877 305 1745

Europe, Middle East & Africa
 44 1403 740290

Asia Pacific
 8610 5669 7148

© 2019 Tridium Inc. All rights reserved. All other trademarks and registered trademarks are properties of their respective owners.

Information and/or specifications published here are current as of the date of publication of this document. Tridium, Inc. reserves the right to change or modify specifications without prior notice. The latest product specifications can be found by contacting our corporate headquarters, Richmond, Virginia. Products or features contained herein may be covered by one or more U.S. or foreign patents. This document may be copied only as expressly authorized by Tridium in writing. It may not otherwise, in whole or in part, be copied, photocopied, reproduced, translated, or reduced to any electronic medium or machine-readable form.